

Made to fit John Deere 9935, 9965-CP770 Doffer Plug Sensor

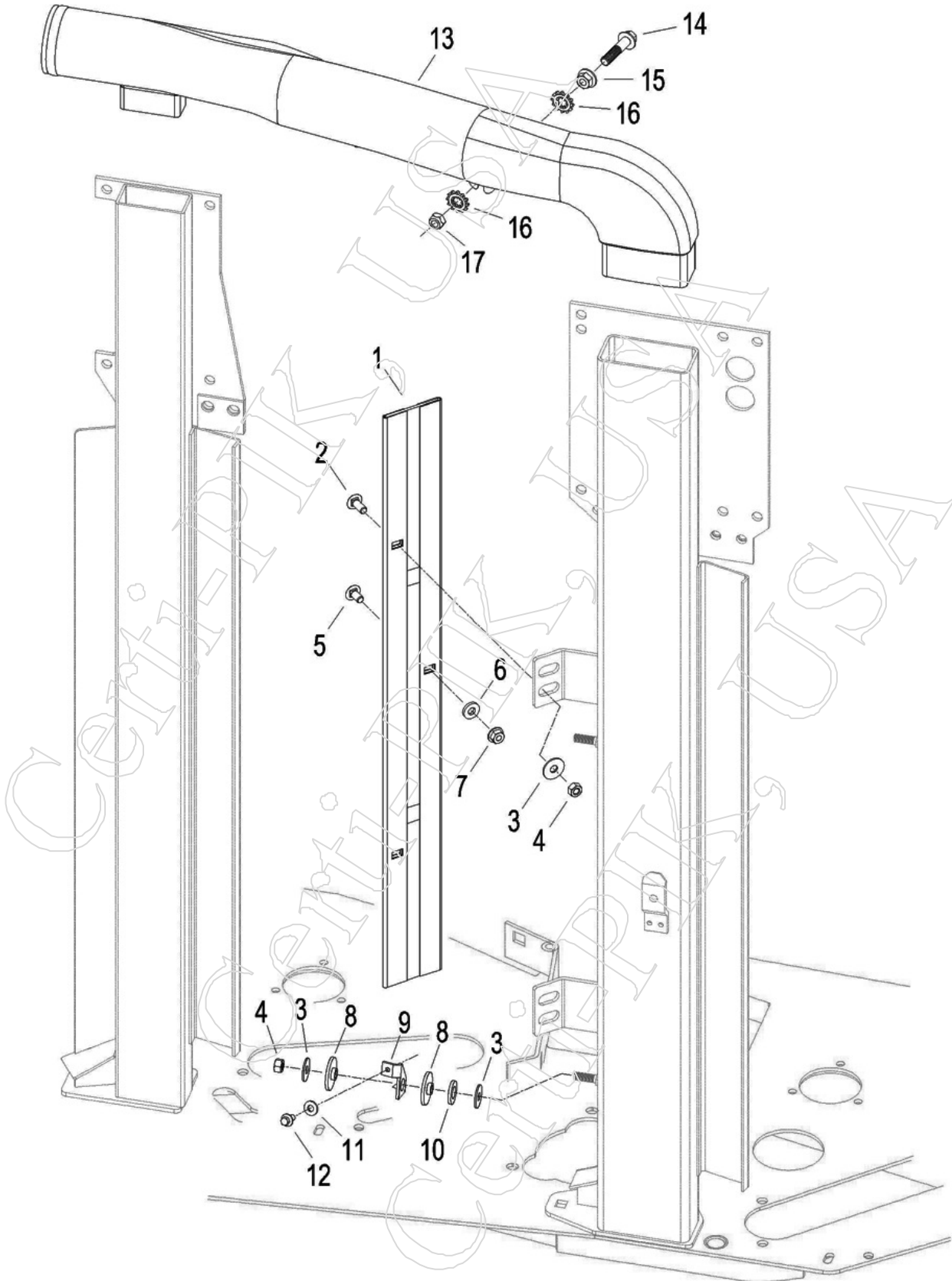

**Made to fit John Deere 9935, 9965-CP770 Doffer Plug Sensor**

20-16

<u>Item</u>	<u>Part</u>	<u>OEMPart</u>	<u>Qty</u>	<u>Desc</u>
1.1	72510	AN272510	1	FLAP - DOFFER PLUG SENSOR (18-SPINDLE)
1.2	73420	AN273420	1	FLAP - DOFFER PLUG SENSOR (20-SPINDLE) (ILL.)
2	07184P	03M7184	1	BOLT - M8 X 20 ROUND HEAD - SHORT SQR NECK
3	47298P	24H7298	1	WASHER - 1.0 X .343 X .06"
4	64256P	E64256P	1	NUT - M8 - TOP LOCK
5	07183P	03M7183	1	BOLT - M8 X 16 ROUND HEAD - SQR NECK
6	01292P	24H1292	1	WASHER - .75 X .343 X .12"
7	63525P	E63525	1	NUT - M8 - SERR HEX FLANGE
8	77510	N377510	1	WASHER - NON-METALIC - SHOULDER
9	73085	N273085	1	ELECTRICAL CONNECTOR TERMINAL
10	01625P	24H1625	1	WASHER - 17/32 X 1 X .120
11	01287P	24H1287	1	WASHER - 9/32 X 5/8 X .065"
12	07089P	37M7089	1	SCREW - M6 X 12 - SMOOTH HEX FLANGE - THREAD CUTTING
13	51306	KK51306	1	AIR DUCT - (REPLACES KK81086 & KK10781 )
14	07805P	19M7805	1	BOLT - M10 X 45 - SMOOTH HEX FLANGE
15	63526P	E63526	1	NUT - M10 - SERR HEX FLANGE
16	09692P	N209692	1	WASHER - 10mm STAR LOCK
17	82222P	M82222	1	M10 X 1.5 TOP LOCK NUT