

Made to fit John Deere Spindle Drive Shaft Assembly

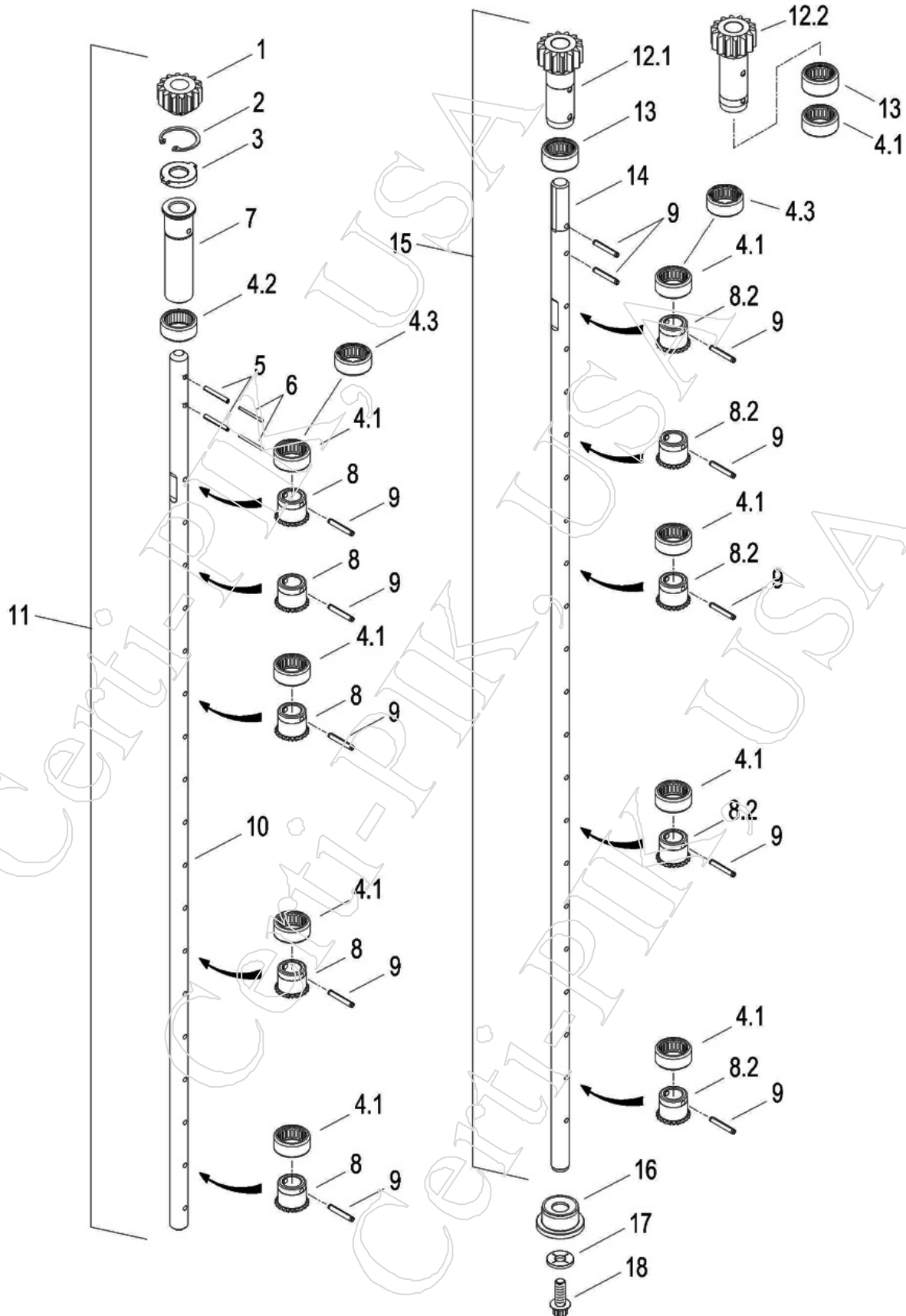

Made to fit John Deere Spindle Drive Shaft Assembly

30-3

<u>Item</u>	<u>Part</u>	<u>OEMPart</u>	<u>Qty</u>	<u>Desc</u>
1	18289	N118289	1	DRIVE GEAR (9900-CP770)
2	23694P	T23694	1	SNAP RING (9900-CP770)
3.1	90988P	N190988	1	THRUST WASHER
3.2	78781	N278781	1	PRO THRUST WASHER - WILL FIT ALL MODELS USING #78782 SLEEVE (ILL.)
4.1	08804P	JD8804	4	BEARING - 23 NEEDLES
4.2	08804PFC	JD8804	1	NEEDLE BEARING - FULL COMPLIMENT, USED ON BEARING SLEEVE #78782
4.3	08804PG	JD8804	4	NEEDLE BEARING WITH 8 GREASE NOTCHES - ALLOWS GREASE TO MORE EASILY GET PAST THE BEARING DOWN THE PICKER BAR.
5	00266P	34H266	2	SPRING PIN - 5/32 X 1" - YELLOW FINISH - USED ON TOP OF SPINDLE DRIVE SHAFT ONLY. IN HOLES IN TOP GEAR AND BEARING SLEEVE.
6	00235P	34H235	2	SPRING PIN - 3/32 X 1"
7	78782	N278782	1	BEARING SLEEVE - WILL FIT ALL MODELS USING #78781 THRUST-WASHER
8.1	02456P	L2456N	AR	BEVEL GEAR - SPINDLE DRIVE - 1/8" PIN HOLE
8.2	90768	KK90768	AR	BEVEL GEAR - SPINDLE DRIVE - 5/32" PIN HOLE (REPLACES #N371626)
9.1	00045P	34H45	AR	SPRING PIN - 1/8 X 1"
9.2	00060P	34H60	AR	SPRING PIN - 5/32 X 1" - BLACK FINISH - USED ON SPINDLE DRIVE SHAFT.
10.1	14199	N114199	NA	DRIVE SHAFT - 14 SPINDLE - 1/8" PIN HOLES IN GEARS
10.2	78037	N278037	1	DRIVE SHAFT - 18 SPINDLE - 1/8" PIN HOLES IN GEARS (9900-9976)
10.3	75212	N275212	1	DRIVE SHAFT - 20 SPINDLE - 1/8" PIN HOLES IN GEARS (9900-9976)
10.4	71720	N371720	1	DRIVE SHAFT - PRO 12 - 18 SPINDLE - 5/32" PIN HOLES IN GEAR (9970-CP690) (ILL.)
10.5	71572	N371572	1	DRIVE SHAFT - PRO 16 - 20 SPINDLE - 5/32" PIN HOLES IN GEAR (9976-CP770)
11.1	76737-K	AN276737	1	** KIT ** 20 SPINDLE (PRO) DRIVE SHAFT (NOT ASSEMBLED) - 5/32 GEAR & SHAFT HOLES
11.2	76743-K	AN276743	1	** KIT ** 18 SPINDLE (PRO) DRIVE SHAFT (NOT ASSEMBLED) - 5/32 GEAR & SHAFT HOLES
12.1	85567	KK85567	1	TOP GEAR - WITH SLEEVE - (CP770) - PRIMARILY USED WITH STEEL SHAFT (1-BRG)
12.2	21391	KK121391	1	TOP GEAR - WITH SLEEVE - (CP770) (REPLACES KK85567) - PRIMARILY USED WITH ALUMINUM SHAFT (2-BRGS)
13	39633P	AKK39633	1	NEEDLE BEARING - SEALED - 23 NEEDLES (TOP POSITION ONLY)
14	85411	KK85411	1	20 SPINDLE DRIVE SHAFT - (CP770) - STEEL FOR INCREASED DURABILITY
15	45882-K	AKK45882	1	** KIT ** 20 SPINDLE (CP770) DRIVE SHAFT KIT (NOT ASSEMBLED) - 5/32 GEAR & SHAFT HOLES
16	14503	KK14503	1	LOWER BAR BUSHING (CP770) (USED WITH #78364P PIVOT)
17	14504	KK14504	1	THRUST WASHER - FOR CP770 DRIVE SHAFT
18	78365P	KK78365	1	12 POINT BOLT - FOR CP770 SPINDLE DRIVE SHAFT